

FCI CONFIDENTIAL

FCI

This document is the property of and embodies CONFIDENTIAL and PROPRIETARY information of FCI. No part of the information shown on this document may be used in any way or disclosed to others without the written consent of FCI. Copyright FCI.

FCIconnect.com

PRODUCT NO.

94898

PRODUCT NO.	STAND OFF	SOLDER TAIL	DIM "P" (mm)	DIM "Q" (mm)	FOR LOWER DECK OR UPPER DECK	⊕ HOLD DOWN	SHEET NO.	MOUNTING STYLE TO PCB		
94898-XXXX	DIM "M" (mm)									
000	0	R/A	2.8	—	LOWER	NONE	NO.2	TOP MOUNT		
△ 000LF	0	R/A	2.8	—	LOWER	NONE				
000MLF	0	R/A	2.8	—	LOWER	NONE				
000H	0	R/A	2.8	—	LOWER	YES				
△ 000HLF	0	R/A	2.8	—	LOWER	YES				
001	0	SMT STAGGERED	—	—	LOWER	NONE				
△ 001LF	0	SMT STAGGERED	—	—	LOWER	NONE				
001H	0	SMT STAGGERED	—	—	LOWER	YES				
△ 001HLF	0	SMT STAGGERED	—	—	LOWER	YES				
002	0	SMT IN LINE	—	—	LOWER	NONE				
△ 002LF	0	SMT IN LINE	—	—	LOWER	NONE	NO.3	BOTTOM MOUNT 94898-5XXX		
002H	0	SMT IN LINE	—	—	LOWER	YES				
△ 002HLF	0	SMT IN LINE	—	—	LOWER	YES				
010	4	R/A	2.8	—	LOWER	NONE				
△ 010LF	4	R/A	2.8	—	LOWER	NONE				
020	5	R/A	2.8	—	LOWER	NONE				
△ 020LF	5	R/A	2.8	—	LOWER	NONE				
△ 020MLF	5	R/A	2.8	—	LOWER	NONE				
△ 021MLF	5	R/A	2.8	—	LOWER	NONE				
040	2	R/A	2.5	—	LOWER	NONE				
△ 040MLF	2	R/A	2.5	—	LOWER	NONE	NO.4	TOP MOUNT 94898-0XXX		
△ 040LF	2	R/A	2.5	—	LOWER	NONE				
005	FOR 0	R/A	2.8	8.6	UPPER	NONE				
△ 005LF	FOR 0	R/A	2.8	8.6	UPPER	NONE				
045	FOR 2	R/A	2.5	10.3	UPPER	NONE				
△ 045MLF	FOR 2	R/A	2.5	10.3	UPPER	NONE				
△ 045LF	FOR 2	R/A	2.5	10.3	UPPER	NONE				
500	0	R/A	2.8	—	LOWER	NONE			NO.5	BOTTOM MOUNT 94898-5XXX
△ 500LF	0	R/A	2.8	—	LOWER	NONE				
500H	0	R/A	2.8	—	LOWER	YES				
△ 500HLF	0	R/A	2.8	—	LOWER	YES				
501	0	SMT STAGGERED	—	—	LOWER	NONE				
△ 501LF	0	SMT STAGGERED	—	—	LOWER	NONE				
501H	0	SMT STAGGERED	—	—	LOWER	YES				
△ 501HLF	0	SMT STAGGERED	—	—	LOWER	YES				
502	0	SMT IN LINE	—	—	LOWER	NONE				
△ 502J	0	SMT IN LINE	—	—	LOWER	NONE				
△ 502LF	0	SMT IN LINE	—	—	LOWER	NONE	NO.6	TOP MOUNT 94898-0XXX		
502H	0	SMT IN LINE	—	—	LOWER	YES				
△ 502HLF	0	SMT IN LINE	—	—	LOWER	YES				
510	4	R/A	2.8	—	LOWER	NONE				
△ 510LF	4	R/A	2.8	—	LOWER	NONE				
520	5	R/A	2.8	—	LOWER	NONE				
△ 520LF	5	R/A	2.8	—	LOWER	NONE				
530	2	R/A	1.48	—	LOWER	NONE				
△ 530LF	2	R/A	1.48	—	LOWER	NONE				
540	2	R/A	2.5	—	LOWER	NONE				
△ 540LF	2	R/A	2.5	—	LOWER	NONE	NO.7	TOP MOUNT 94898-0XXX		
505	FOR 0	R/A	2.8	8.6	UPPER	NONE				
△ 505LF	FOR 0	R/A	2.8	8.6	UPPER	NONE				
535	FOR 2	R/A	1.48	9.28	UPPER	NONE				
△ 535LF	FOR 2	R/A	1.48	9.28	UPPER	NONE				
545	FOR 2	R/A	2.5	10.3	UPPER	NONE				
△ 545LF	FOR 2	R/A	2.5	10.3	UPPER	NONE				

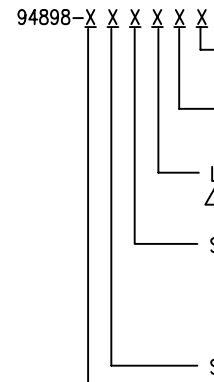
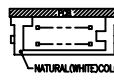
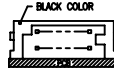

- NONE : N 0
- △ LF : YES
- NONE : N 0
- H : YES (SEE FIGURE OF -xxxH)
- NONE : N 0
- M : YES (DETAIL AS COMPONENT)
- 0 : R/A (FOR LOWER & SINGLE)
- 1 : SMT STAGGERED (FOR LOWER ONLY)
- 2 : SMT IN LINE (FOR LOWER ONLY)
- 5 : R/A (FOR UPPER ONLY)
- 0 : 0mm
- 1 : 4mm
- 2 : 5mm
- 3 : 2mm (SPECIAL TAIL LENGTH)
- 4 : 2mm
- 0 : TOP MOUNTING
- 5 : BOTTOM MOUNTING

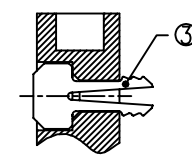
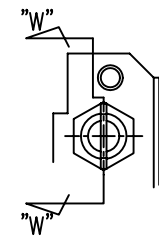

SECTION "W"-"W"

94898-xxxH  
(OPTIONAL HOLD DOWN)

mat'l. code		surface ISO 1302		tolerance ISO 406 ISO 101		projection		product family	
ltr		ecn no		dr		date		title	
F		N05-0032		M.H		2/15/05		68 POS EJECTOR HEADER ASSY FOR LOW VOLTAGE	
G		N05-0046		M.H		3/2/05			
H		N05-0280		M.Z		11/08/05			
J		N06-0065		M.Z		04/02/06		dwg no	
K		N07-0219		M.Z		12/07/07		94898	
L		N08-0041		M.Z		03/10/08		sheet 1 of 7 size	
								A4	
								type CUSTOMER Drawing	
sheet		revision		L		L		L	
index		sheet		1		2		3	

FCI CONFIDENTIAL

FCI

This document is the property of and embodies CONFIDENTIAL and PROPRIETARY information of FCI. No part of the information shown on this document may be used in any way or disclosed to others without the written consent of FCI. Copyright FCI.

PRODUCT NO.
94898-000
94898-000LF
94898-000H
94898-000HLF
94898-000MLF
94898-001
94898-001LF
94898-001H
94898-001HLF
94898-002
94898-002LF
94898-002H
94898-002HLF

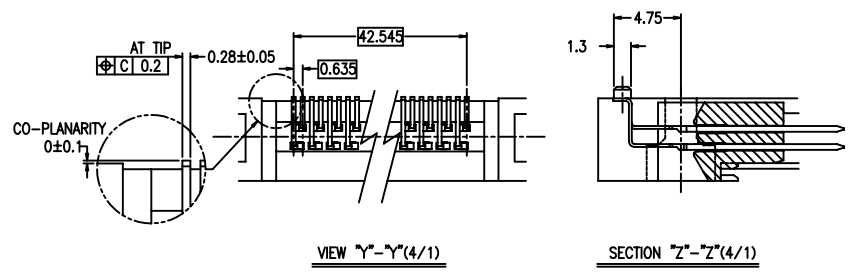
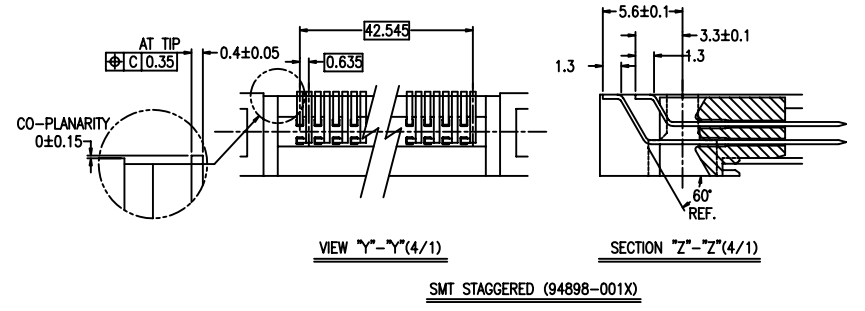
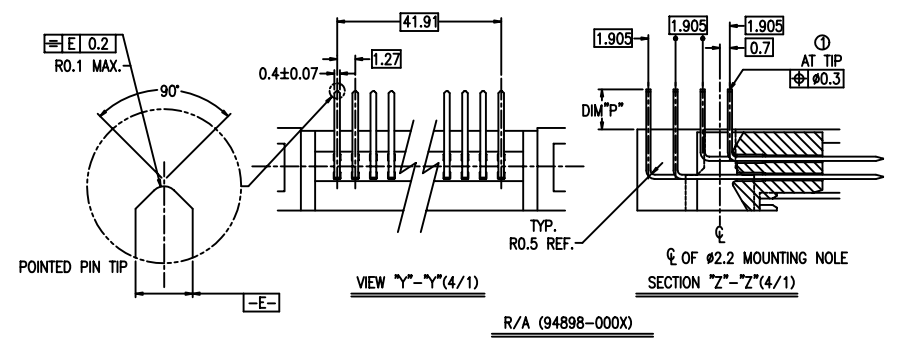
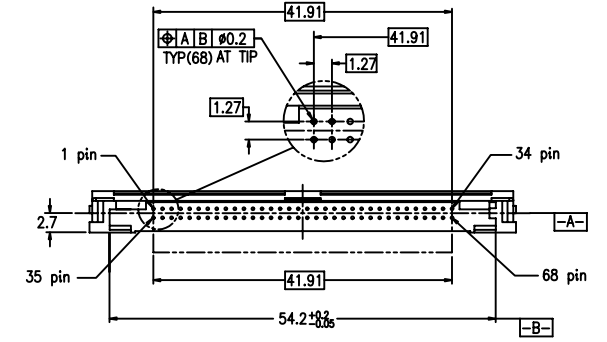
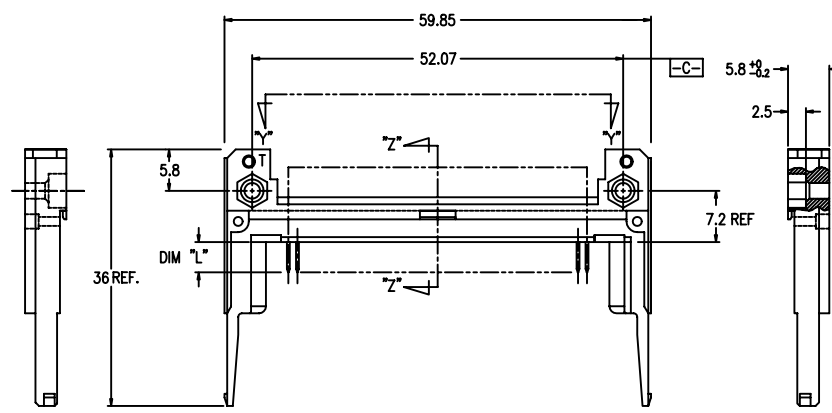

- NOTES
- TRUE POSITION IS A FREE GRID TO PIN PATTERN ITSELF.
  - SEE TA-946 FOR PCB LAYOUT.
  - MATERIAL  
HOUSING : LCP UL94V-0 BLACK.  
PIN : PHOSPHOR BRONZE.  
HOLD-DOWN : BRASS
  - FINISH  
PIN  
UNDER PLATING : 0.5µm MIN. Ni.  
CONTACT AREA : 0.1µm MIN. Au.  
OVER 0.5µm MIN. Pd-Ni.  
SOLDER AREA : 2.5µm MIN. Sn-Pb.  
OR 2.5µm MIN. PURE Sn.(FOR -XXXLF)  
HOLD-DOWN : 2.5µm MIN. PURE Sn.
  - RECOMMENDED PCB HOLE (OPTIONAL HOLD-DOWN) : 2.3±0.1
  - SEQUENCE PIN ASSIGNMENT

PIN No.	DIM "L"		
	4.25±0.1	3.5±0.1	5.0±0.1
OTHERS	36.67	1.17	35.51

- IF LEAD FREE P/N, THE HOUSING WILL WITHSTAND EXPOSURE TO 260° C PEAK TEMPERATURE FOR 10 SECONDS IN A WAVE SOLDER APPLICATION WITH A 1.00MM MINIMUM THICK CIRCUIT BOARD.
- LEAD FREE PRODUCT MEETS EUROPEAN UNION DIRECTIVES AND OTHER COUNTRY REGULATIONS AS DISCRIBLED IN GS-22-008
- IF LEAD FREE P/N, PACKAGE MEETS GS-14-920 SPECIFICATION

mat'l. code		surface	tolerance	projection	product family
ltr ecn no dr date		ISO 1302	ISO 406 ISO 101		
tolerances unless otherwise specified					title
angles linear					68 POS EJECTOR HEADER ASSY FOR LOW VOLTAGE
±2'					scale
dr M. Hasegawa 2/24/05					
enr M. Hasegawa 2/24/05					
chr					
appd					
sheet index	revision sheet				dwg no 94898 sheet 2 of 7 size A4 type CUSTOMER Drawing

FCI CONFIDENTIAL



This document is the property of and embodies CONFIDENTIAL and PROPRIETARY information of FCI. No part of the information shown on this document may be used in any way or disclosed to others without the written consent of FCI. Copyright FCI.

PRODUCT NO.
94898-010
△ 94898-010LF
94898-020/020M
△ 94898-020LF/020MLF
△ 94898-021MLF
94898-040
△ 94898-040LF/040MLF

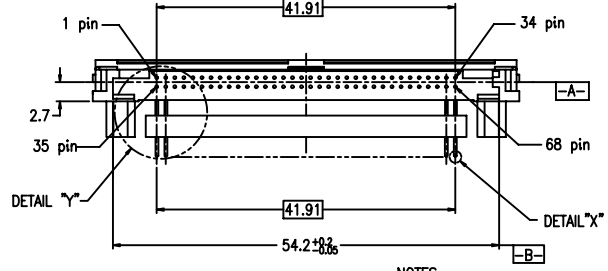
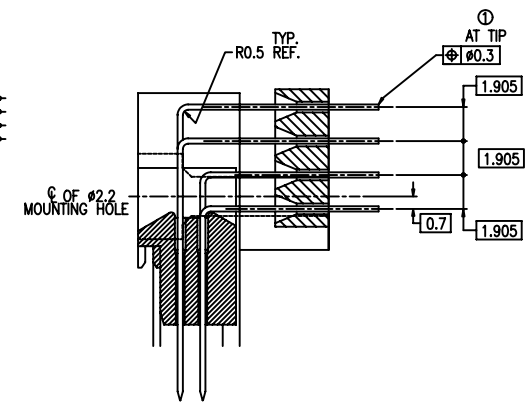
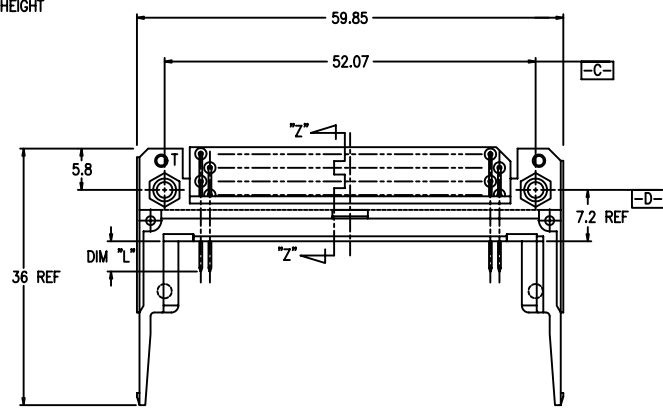
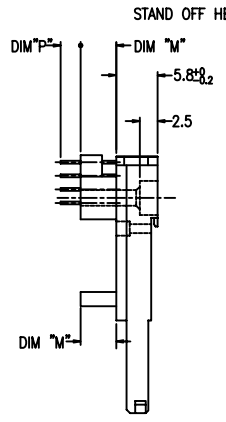

NOTES

- TRUE POSITION IS A FREE GRID TO PIN PATTERN ITSELF.
- SEE TA-946 FOR PCB LAYOUT.
- MATERIAL  
HOUSING : LCP UL94V-0 BLACK.  
PIN : PHOSPHOR BRONZE.  
HOLD-DOWN : BRASS
- FINISH  
PIN  
UNDER PLATING : 0.5µm MIN. Ni.  
CONTACT AREA : 0.1µm MIN. Au.  
OVER 0.5µm MIN. Pd-Ni.  
SOLDER AREA : 2.5µm MIN. Sn-Pb.  
OR 2.5µm MIN. PURE Sn.(FOR -XXXLF)  
HOLD-DOWN : 2.5µm MIN. PURE Sn.
- RECOMMENDED PCB HOLE (OPTIONAL HOLD-DOWN) : 2.3±0.1
- SEQUENCE PIN ASSIGNMENT

PIN No.	DIM "L"		
	4.25±0.1	3.5±0.1	5.0±0.1
OTHERS	1.17±0.04	36.67	35.51±0.08

- GENERAL TOLERANCE : ±0.3
- SEE SHEET 1 REGARDING COMPONENTS.

- IF LEAD FREE P/N, THE HOUSING WILL WITHSTAND EXPOSURE TO 260° C PEAK TEMPERATURE FOR 10 SECONDS IN A WAVE SOLDER APPLICATION WITH A 1.00MM MINIMUM THICK CIRCUIT BOARD.
- LEAD FREE PRODUCT MEETS EUROPEAN UNION DIRECTIVES AND OTHER COUNTRY REGULATIONS AS DESCRIBED IN GS-22-008
- IF LEAD FREE P/N, PACKAGE MEETS GS-14-920 SPECIFICATION
- "M" SHOWS IT IS LOW COST VERSION, IT IS OPTIONAL AND IN FIRST OF LETTER OF PART NO., SUCH AS 94898-020MLF IS LOW COST VERSION 94898-020LF IS NOT LOW COST VERSION.

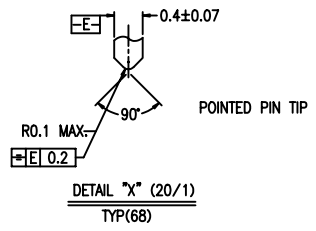
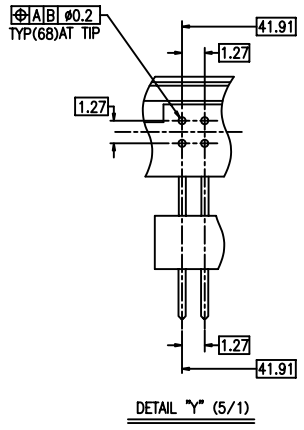

mat'l. code		surface	tolerance	projection	product family
		ISO 1302	ISO 406 ISO 1101		
ltr ecn no dr date		tolerances unless otherwise specified			title
		angles	linear	MM	68 POS EJECTOR HEADER ASSY FOR LOW VOLTAGE
		±2'		scale	
		dr	M. Hasegawa	2/24/05	dwg no 94898 sheet 3of 7 size A4
		enr	M. Hasegawa	2/24/05	
		chr			
		appd			
sheet index	revision sheet				type CUSTOMER Drawing

FCI CONFIDENTIAL

This document is the property of and embodies CONFIDENTIAL and PROPRIETARY information of FCI. No part of the information shown on this document may be used in any way or disclosed to others without the written consent of FCI. Copyright FCI.

PRODUCT NO.
94898-005
94898-005LF
94898-045
94898-045LF

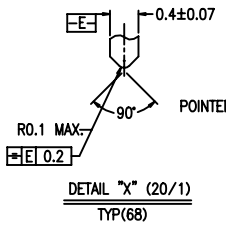
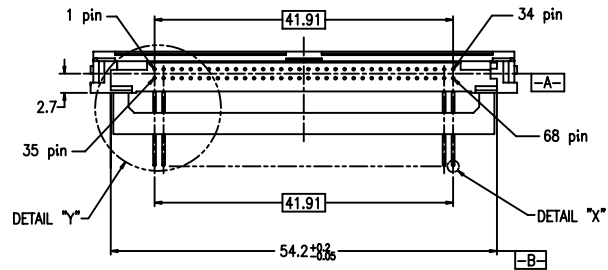
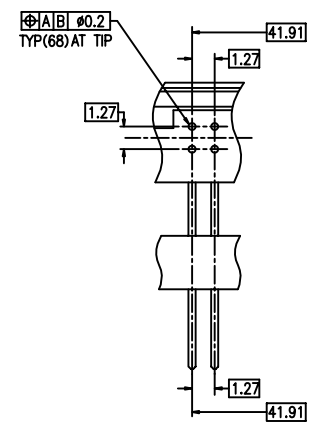
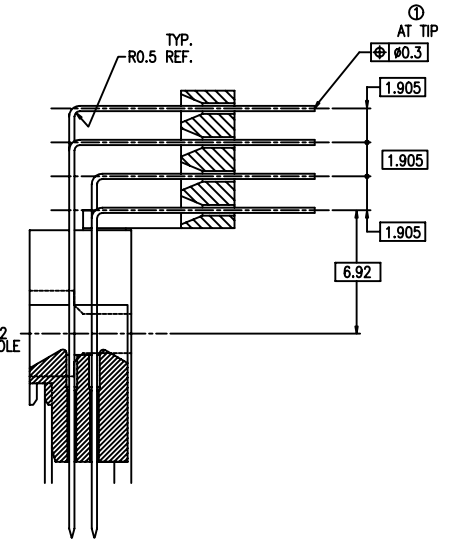
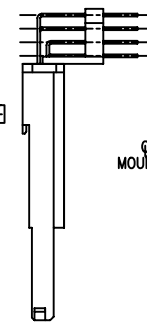
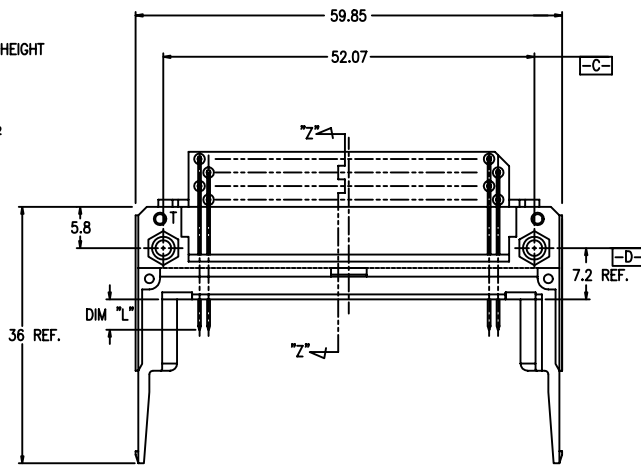
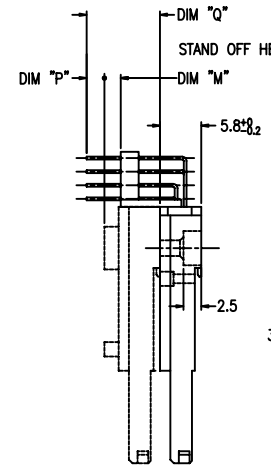

NOTES

- TRUE POSITION IS A FREE GRID TO PIN PATTERN ITSELF.
- SEE TA-946 FOR PCB LAYOUT.
- MATERIAL  
HOUSING : LCP UL94V-0 BLACK.  
PIN : PHOSPHOR BRONZE.  
HOLD-DOWN : BRASS
- FINISH PIN  
UNDER PLATING : 0.5µm MIN. Ni.  
CONTACT AREA : 0.1µm MIN. Au.  
OVER 0.5µm MIN. Pd-Ni.  
SOLDER AREA : 2.5µm MIN. Sn-Pb.  
OR 2.5µm MIN. PURE Sn.(FOR -XXXLF)  
HOLD-DOWN : 2.5µm MIN. PURE Sn.
- RECOMMENDED PCB HOLE (OPTIONAL HOLD-DOWN) : 2.3±0.1
- SEQUENCE PIN ASSIGNMENT
- IF LEAD FREE P/N, THE HOUSING WILL WITHSTAND EXPOSURE TO 260° C PEAK TEMPERATURE FOR 10 SECONDS IN A WAVE SOLDER APPLICATION WITH A 1.00MM MINIMUM THICK CIRCUIT BOARD.
- LEAD FREE PRODUCT MEETS EUROPEAN UNION DIRECTIVES AND OTHER COUNTRY REGULATIONS AS DISCRIBED IN GS-22-008
- IF LEAD FREE P/N, PACKAGE MEETS GS-14-920 SPECIFICATION

PIN No.	DIM "L"		
	4.25±0.1	3.5±0.1	5.0±0.1
OTHERS	36.67	35.51	35.51

- GENERAL TOLERANCE : ±0.3
- SEE SHEET 1 REGARDING COMPONENTS.

mat'l. code		surface	tolerance	projection	product family
		ISO 1302	ISO 406 ISO 1101		
ltr ecn no dr date		tolerances unless otherwise specified			title
					68 POS EJECTOR HEADER ASSY FOR LOW VOLTAGE
L		angles	linear	MM	
		±2'		scale	
		dr	M. Hasegawa	2/24/05	dwg no 94898 sheet 4 of 7 size A4 type CUSTOMER Drawing
		enrg	M. Hasegawa	2/24/05	
		chr			
		appd			
sheet index	revision sheet				

FCI CONFIDENTIAL

This document is the property of and embodies CONFIDENTIAL and PROPRIETARY information of FCI. No part of the information shown on this document may be used in any way or disclosed to others without the written consent of FCI. Copyright FCI.

PRODUCT NO.
94898-500
94898-500LF
94898-500H
94898-500HLF
94898-501
94898-501LF
94898-501H
94898-501HLF
94898-502
94898-502J
94898-502LF
94898-502H
94898-502HLF

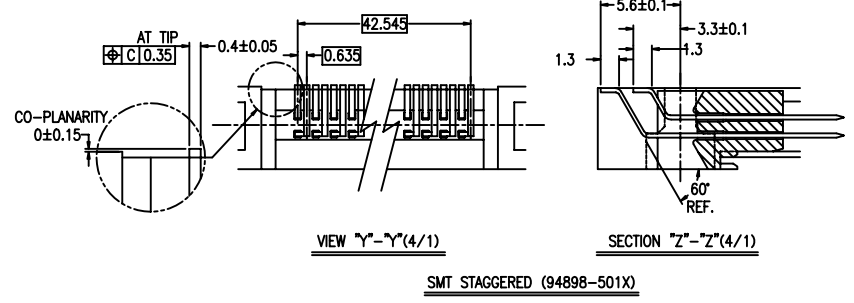
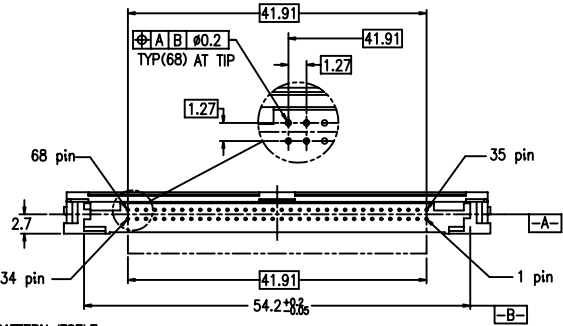
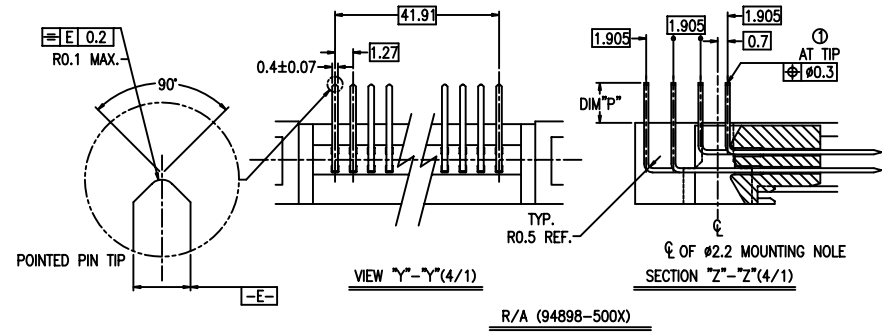
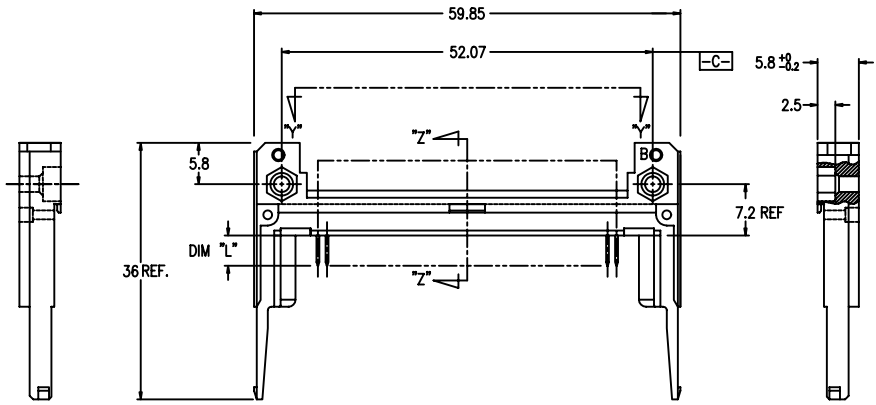

**NOTES**

- TRUE POSITION IS A FREE GRID TO PIN PATTERN ITSELF.
- SEE TA-946 FOR PCB LAYOUT.
- MATERIAL**  
 HOUSING : LCP UL94V-0 NATURAL.  
 PIN : PHOSPHOR BRONZE.  
 HOLD-DOWN : BRASS
- FINISH PIN**  
 UNDER PLATING : 0.5µm MIN. Ni.  
 CONTACT AREA : 0.1µm MIN. Au.  
 OVER 0.5µm MIN. Pd-Ni.  
 SOLDER AREA : 2.5µm MIN. Sn-Pb.  
 OR 2.5µm MIN. PURE Sn.(FOR -XXXLF)  
 HOLD-DOWN : 2.5µm MIN. PURE Sn.
- RECOMMENDED PCB HOLE (OPTIONAL HOLD-DOWN) : 2.3±0.1

**6. SEQUENCE PIN ASSIGNMENT**

PIN No.	DIM "L"	
	4.25±0.1	5.0±0.1
OTHERS	36.67	35.168

- GENERAL TOLERANCE : ±0.3
- SEE SHEET 1 REGARDING COMPONENTS.
- IF LEAD FREE P/N, THE HOUSING WILL WITHSTAND EXPOSURE TO 260° C PEAK TEMPERATURE FOR 10 SECONDS IN A WAVE SOLDER APPLICATION WITH A 1.00MM MINIMUM THICK CIRCUIT BOARD.
- LEAD FREE PRODUCT MEETS EUROPEAN UNION DIRECTIVES AND OTHER COUNTRY REGULATIONS AS DISCRIBED IN GS-22-008
- IF LEAD FREE P/N, PACKAGE MEETS GS-14-920 SPECIFICATION
- THE P/N 94898-502J HAS SPECIAL TRAY, IT IS 10084720-001.

mat'l. code		surface	tolerance	projection	product family
		ISO 1302	ISO 406 ISO 101		
ltr	ecn no	dr	date	tolerances unless otherwise specified	
L				angles	linear
				±2'	MM
				scale	
		dr	M. Hasegawa	2/24/05	title 68 POS EJECTOR HEADER ASSY FOR LOW VOLTAGE  dwg no 94898 sheet 5 of 7 size A4 type CUSTOMER Drawing
		enr	M. Hasegawa	2/24/05	
		chr			
		appd			
sheet	revision				
index	sheet				

FCI CONFIDENTIAL

FCI

This document is the property of and embodies CONFIDENTIAL and PROPRIETARY information of FCI. No part of the information shown on this document may be used in any way or disclosed to others without the written consent of FCI. Copyright FCI.

FCIconnect.com

PRODUCT NO.	
94898-510	94898-510LF
94898-520	94898-520LF
94898-530	94898-530LF
94898-540	94898-540LF

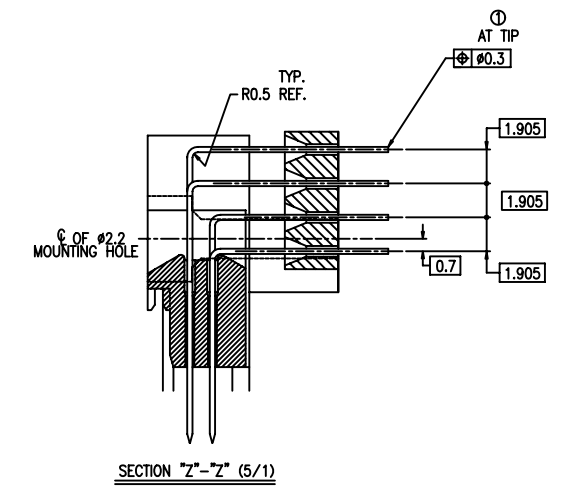
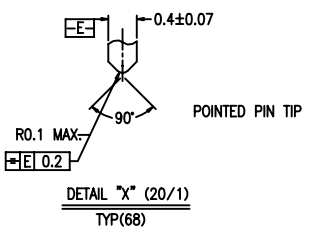
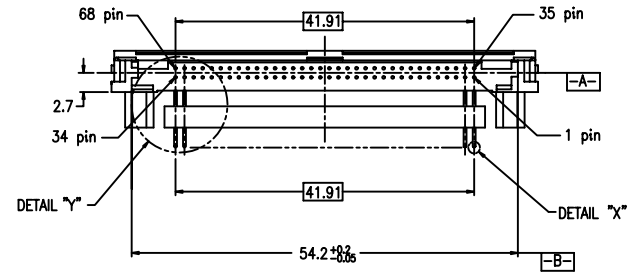
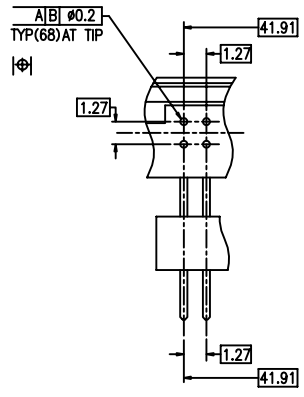
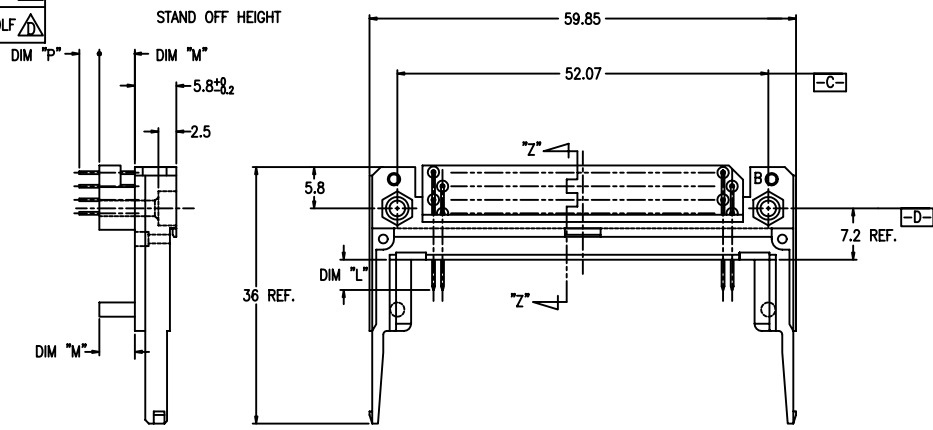

NOTES

- TRUE POSITION IS A FREE GRID TO PIN PATTERN ITSELF.
- SEE TA-946 FOR PCB LAYOUT.
- MATERIAL  
HOUSING : LCP UL94V-0 NATURAL  
PIN : PHOSPHOR BRONZE.  
HOLD-DOWN : BRASS
- FINISH  
PIN  
UNDER PLATING : 0.5µm MIN. Ni.  
CONTACT AREA : 0.1µm MIN. Au.  
OVER 0.5µm MIN. Pd-Ni.  
SOLDER AREA : 2.5µm MIN. Sn-Pb.  
OR 2.5µm MIN. PURE Sn.(FOR -XXXLF)  
HOLD-DOWN : 2.5µm MIN. PURE Sn.
- RECOMMENDED PCB HOLE (OPTIONAL HOLD-DOWN) : 2.3±0.1
- SEQUENCE PIN ASSIGNMENT
- IF LEAD FREE P/N, THE HOUSING WILL WITHSTAND EXPOSURE TO 260° C PEAK TEMPERATURE FOR 10 SECONDS IN A WAVE SOLDER APPLICATION WITH A 1.00MM MINIMUM THICK CIRCUIT BOARD.
- LEAD FREE PRODUCT MEETS EUROPEAN UNION DIRECTIVES AND OTHER COUNTRY REGULATIONS AS DISCRIBLED IN GS-22-008
- IF LEAD FREE P/N, PACKAGE MEETS GS-14-920 SPECIFICATION

PIN No.	DIM "I"		
	4.25±0.1	3.5±0.1	5.0±0.1
OTHERS	36.67	35.57	35.57

- GENERAL TOLERANCE : ±0.3
- SEE SHEET 1 REGARDING COMPONENTS.

mat'l. code		surface	tolerance	projection	product family
		ISO 1302	ISO 406 ISO 1101		
ltr ecn no dr date					tolerances unless otherwise specified
L					title
					68 POS EJECTOR HEADER ASSY FOR LOW VOLTAGE
					angles linear
					±2'
					scale
					MM
					dr M. Kasagawa 2/24/05
					enr M. Kasagawa 2/24/05
					chr
					appd
					FCI
					dwg no 94898 sheet 6 of 7 size A4
					type CUSTOMER Drawing
sheet index	revision sheet				

PRODUCT NO.
94898-505
94898-505LF
94898-535
94898-535LF
94898-545
94898-545LF

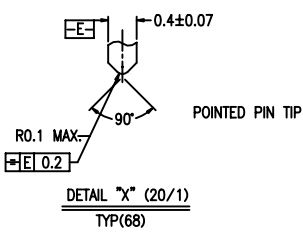
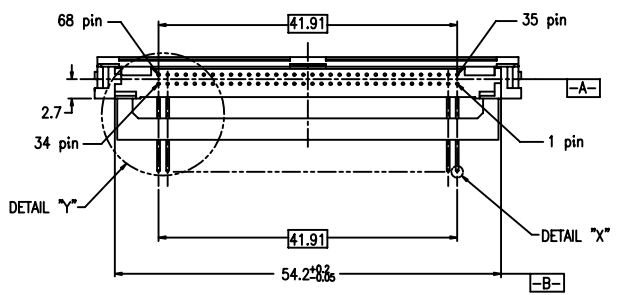
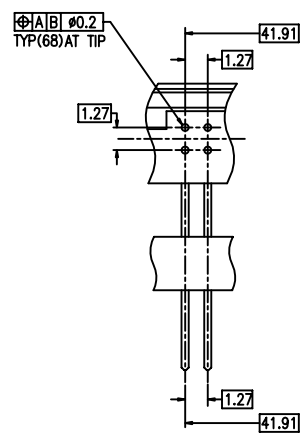
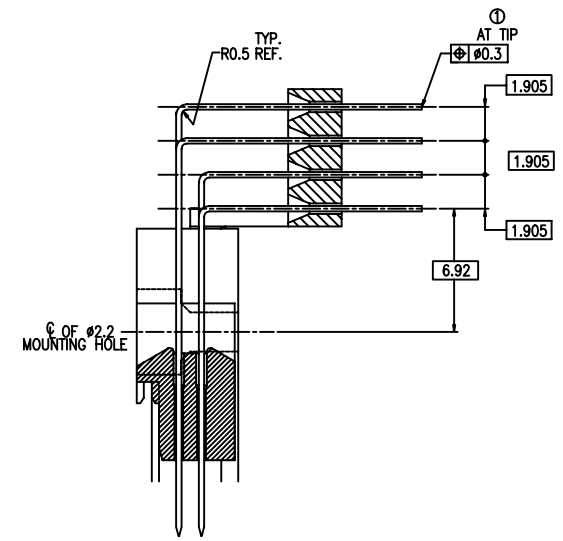
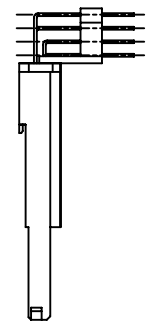
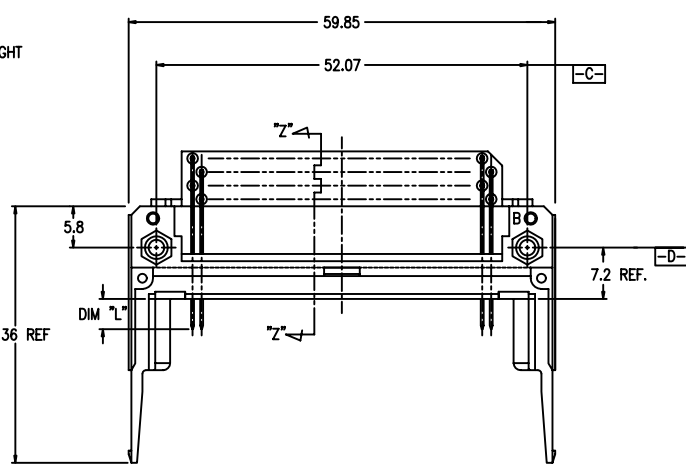
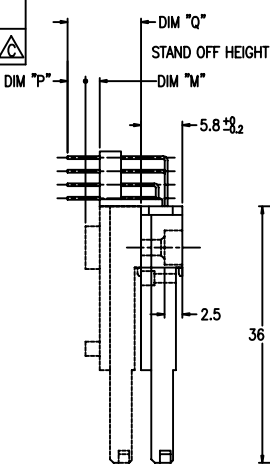

- NOTES
- TRUE POSITION IS A FREE GRID TO PIN PATTERN ITSELF.
  - SEE TA-946 FOR PCB LAYOUT.
  - MATERIAL  
HOUSING : LCP UL94V-0 NATURAL  
PIN : PHOSPHOR BRONZE  
HOLD-DOWN : BRASS
  - FINISH PIN  
UNDER PLATING : 0.5µm MIN. Ni.  
CONTACT AREA : 0.1µm MIN. Au.  
OVER 0.5µm MIN. Pd-Ni.  
SOLDER AREA : 2.5µm MIN. Sn-Pb.  
OR 2.5µm MIN. PURE Sn.(FOR -XXXLF)  
HOLD-DOWN : 2.5µm MIN. PURE Sn.
  - RECOMMENDED PCB HOLE (OPTIONAL HOLD-DOWN) : 2.3±0.1
  - SEQUENCE PIN ASSIGNMENT
  - GENERAL TOLERANCE : ±0.3
  - SEE SHEET 1 REGARDING COMPONENTS.
  - IF LEAD FREE P/N, THE HOUSING WILL WITHSTAND EXPOSURE TO 260° C PEAK TEMPERATURE FOR 10 SECONDS IN A WAVE SOLDER APPLICATION WITH A 1.00MM MINIMUM THICK CIRCUIT BOARD.
  - LEAD FREE PRODUCT MEETS EUROPEAN UNION DIRECTIVES AND OTHER COUNTRY REGULATIONS AS DISCRIBED IN GS-22-008
  - IF LEAD FREE P/N, PACKAGE MEETS GS-14-920 SPECIFICATION

	DIM "M"		
	4.25±0.1	3.5±0.1	5.0±0.1
PIN No.	OTHERS	36,67	1,17,34,35,51,68

mat'l. code		surface	tolerance	projection	product family
		ISO 1302	ISO 406 ISO 1101		
ltr ecn no dr date		tolerances unless otherwise specified			title
L		angles linear			68 POS EJECTOR HEADER ASSY FOR LOW VOLTAGE
		±2'			scale
		dr	M. Hasegawa	2/24/05	dwg no 94898 sheet 7 of 7 size A4 type CUSTOMER Drawing
		enr	M. Hasegawa	2/24/05	
		chr			
		appd			
sheet index	revision sheet				